

SELECTION GUIDE

RT™/RTE™ Series Frame Hangers

LIT NO: 45745-038

DATE: July 2010

REVISION: E

CONTENTS

	PAGE
■ Introduction • Guide Instructions	2
■ #1 Front Frame Hanger	
Clamp Mount	3-4
Under Mount RT 650	4
Flange Mount	5
Web Mount	5
■ #2 Rear Frame Hanger	
Clamp Mount	6-7
Flange Mount	8
Web Mount	9
Under Mount RT 650	9
■ #3 Extended Leaf Frame Hanger	
Outboard	10
Inboard	11

RT/RTE 340/343/400/403/460/463

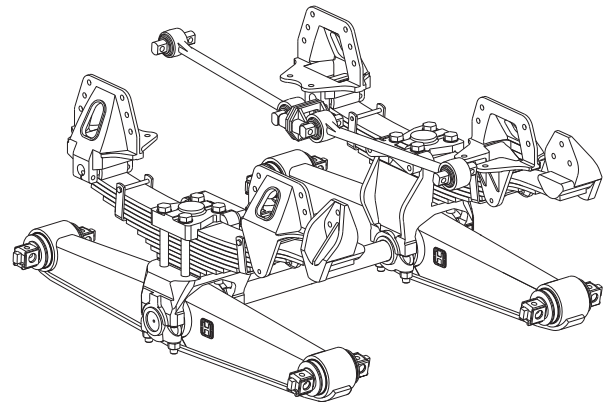

RT/RTE 480/503/520/523

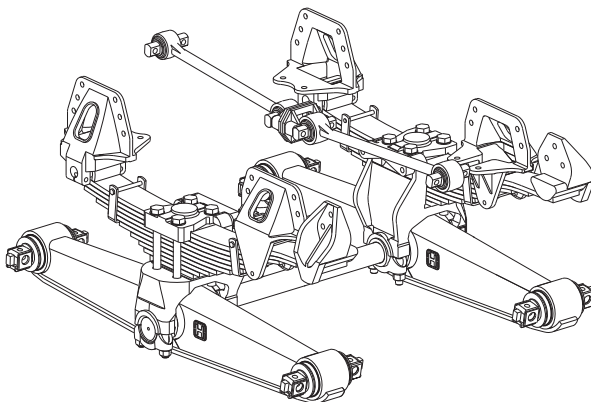

HEAVY DUTY RT 650

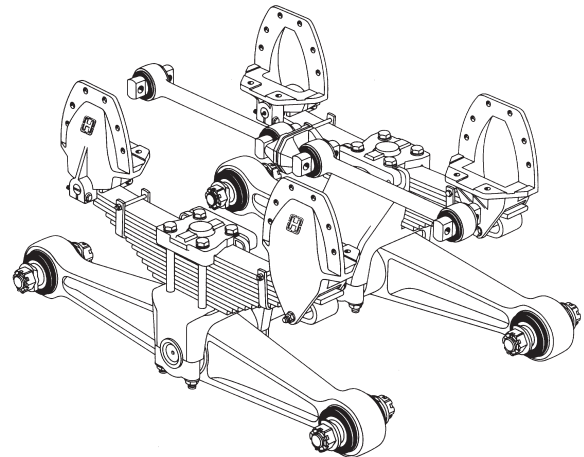

Common Drill Patterns and Castings

Introduction

This RT/RTE Frame Hanger guide is intended to aid in the proper identification and aftermarket replacement of originally equipped RT/RTE/RU/RUE/U/UE drilled hangers.

Refer to RT/RTE suspension publication Nos. SP-168, 17730-070, 17730-190, 17730-213, and 17730-214 for additional information on proper maintenance, service, repair and rebuild instructions.

Guide Instructions

STEP 1

Identify hanger.

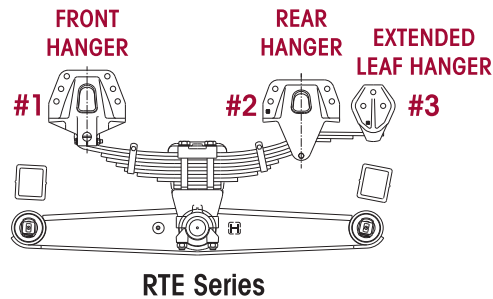
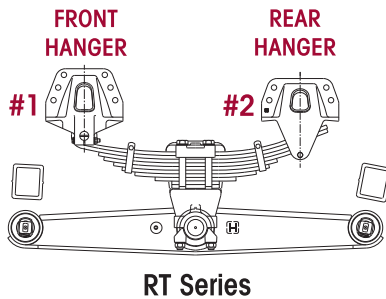

STEP 2

Identify **FRAME HANGER DESIGN**. The three hanger designs - Clamp Mount, Web Mount or Flange Mount vary in the attachment to the lower frame flange.

NOTE: For replacement RT/RTE hangers, Hendrickson recommends a minimum 5/8" Grade 8 bolt, Grade C locknut and hardened washers be used to attach clamp and web mount frame hangers to the main frame of the vehicle. With older model vehicles this may require that the holes in the frame be enlarged to accommodate the 5/8" fasteners.

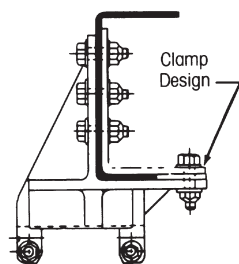

Clamp Mount
Bolts inboard of the frame rail. No holes in the lower frame flange.

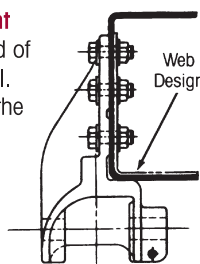

Web Mount
Bolts into frame web only.

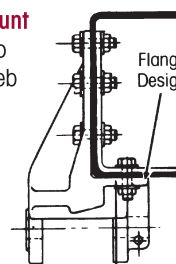

Flange Mount
Bolts through the frame lower flange.
DO NOT use on high tensile steel frames.

STEP 3

Find **BOLT HOLE PATTERN DIMENSIONS**

Common Bolt Hole Patterns	A	B	C
Clamp, Web and flange, 6-Hole	2 9/16"	5 3/8"	7 5/8"
Clamp, 6-Hole	2 9/16"	4 1/2"	6 7/16"
Web, 4-Hole	2 9/16"	5 3/8"	
Web, 3-Hole	1 7/8"	4"	

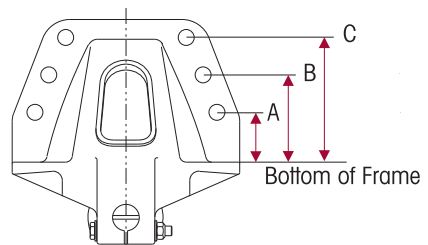

STEP 4

Identify the **YEAR** and **MANUFACTURER** of the vehicle and obtain the **CASTING PART NUMBER**.

For any casting number or truck manufacturer not listed, contact Hendrickson Truck Parts toll-free at 866-755-5968, (email: truckparts@hendrickson-intl.com).

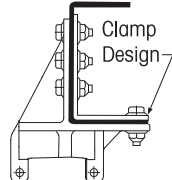
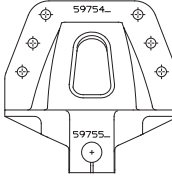
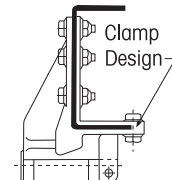
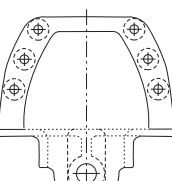

#1 FRONT FRAME HANGER

	1 1/4" SPRING PIN DIAMETER		1 3/8" SPRING PIN DIAMETER		REMARKS	
	CASTING NO.	ORIGINAL PART NO.	REPLACEMENT PART NO.	ORIGINAL PART NO.		REPLACEMENT PART NO.
<p>DOUBLE LOCK</p>  	◆ 46840-000 <i>Replaced By</i> 50180-000	◆ 46840-001 ◆ 46841-002 ◆ 46841-003			Ford Peterbilt	
	◆ 46842-000 <i>Replaced By</i> 50188-000	◆ 46843-001 ◆ 46843-003 ◆ 46843-004			Ford Freightliner	
	◆ 47868-000 <i>Replaced By</i> 50184-000	◆ 47874-001			Mack, Volvo	
	50180-000			50181-001L 50181-002L 50181-003 50181-004 50181-005	Ford Peterbilt International Mack	
	50184-000			50185-001 50185-002 50185-003	Mack, Volvo Freightliner Mack w/ body bound bolts	
	50188-000			50189-001L 50189-003L 50189-004 50189-006	Ford Freightliner International	
	59754-000			59755-001	Volvo	
	<p>SINGLE LOCK</p>  	20395-000	20395-000 25914-000 45014-000	43181-004 43181-004 43181-004	24311-000 25913-000 32503-000 44893-000 45404-001 45404-002	34013-096 34013-096 34013-096 34013-096 34013-096 34013-096
		24496-000	24496-000 ◆ 31345-000	◆ 31345-000	26791-000 29189-000 ◆ 31346-000	◆ 31346-000 ◆ 31346-000
		◆ 28641-000	◆ 30083-000			
43180-000				45729-001 45729-002 45729-003	34013-094 34013-094 34013-094	Mack, Volvo Volvo with 3/4" bolts Mack w/ body bound bolts
45159-000		43181-004		43181-003	34013-096	GMC, Mack, Volvo
45527-000				45528-001 45736-001	34013-093 34013-095	Ford

◆ **Obsolete**, contact Hendrickson Truck Parts for available options.

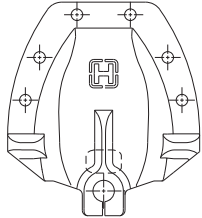

#1 FRONT FRAME HANGER (CONTINUED)

	1 1/2" SPRING PIN DIAMETER			REMARKS
	CASTING NO.	ORIGINAL PART NO.	REPLACEMENT PART NO.	
CLAMP MOUNT 	RT 650			
	◆ 09474-000	◆ 45161-001 ◆ 45161-002 ◆ 45768-001 ◆ 45768-002 ◆ 47381-001 ◆ 47381-002 ◆ 47383-000		Oshkosh Oshkosh Kenworth Kenworth Kenworth
	◆ 33796-000	◆ 33798-000 ◆ 45416-000		GMC, International, Volvo Ford
	◆ 35434-000	◆ 45444-000		
	45789-000	45790-001 45790-002 45790-003 45790-004		Crane Carrier, GMC, Oshkosh, Peterbilt 34.0" Frame, Volvo, Freightliner Peterbilt 35" Frame Peterbilt 34.75" Frame Volvo
	46093-001	◆ 46094-001 ◆ 45029-001	65035-001	Volvo
	46093-002	◆ 46094-002 ◆ 45029-002	65035-002	Volvo
	46548-000	46549-001 46549-002 46549-003 46549-004 46549-005 46549-006 46549-008		Oshkosh, Peterbilt, •Volvo Ford, •GMC International, •Volvo Freightliner, Western Star •GMC, International w/5th wheel clearance Kenworth Peterbilt w/5th wheel clearance

	1 1/2" SPRING PIN DIAMETER			REMARKS
	CASTING NO.	ORIGINAL PART NO.	REPLACEMENT PART NO.	
UNDER MOUNT RT 650 (OBSOLETE)				
◆ 11063-001	◆ 11063-001			Crane Carrier, Seagrave, International

- ◆ **Obsolete**, contact Hendrickson Truck Parts for available options.
- Contact Hendrickson Truck Parts if a casting number has several part number options for the same original equipment manufacturer (OEM), it is necessary to have the vehicle VIN number available for reference.

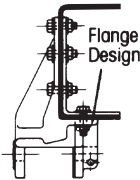
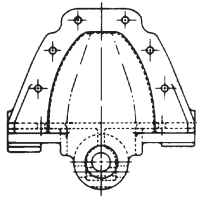
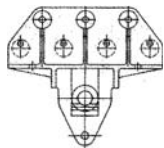

#1 FRONT FRAME HANGER (CONTINUED)

	1¼" SPRING PIN DIAMETER		1⅜" SPRING PIN DIAMETER		REMARKS	
	CASTING NO.	ORIGINAL PART NO.	REPLACEMENT PART NO.	ORIGINAL PART NO.		REPLACEMENT PART NO.
(OBSOLETE)  	◆ 04666-000	◆ 04666-000 ◆ 15582-000 ◆ 24932-000	◆ 47725-001 ◆ 47725-001 ◆ 47725-001	◆ 25641-000 ◆ 26697-000 ◆ 28965-000	◆ 47725-003 ◆ 47725-003 ◆ 47725-003	
	◆ 05810-000	◆ 05810-000 ◆ 08387-000	◆ 05810-000	◆ 19491-000		
	◆ 09170-000	◆ 09170-000 ◆ 30539-000	◆ 09170-000	◆ 25601-000 ◆ 27161-001 ◆ 27161-002	◆ 25601-000 ◆ 25601-000	
	◆ 19818-000			◆ 19818-000		
	◆ 19873-000	◆ 19873-000	◆ 09170-000	◆ 27318-000	◆ 25601-000	
	◆ 19874-000	◆ 19874-000	◆ 09170-000	◆ 27322-000	◆ 25601-000	
	◆ 21554-000			◆ 21554-000	◆ 34977-000	
	◆ 21913-000	◆ 21913-000	◆ 09170-000			
	◆ 25845-000	◆ 25845-000	◆ 09170-000	◆ 28287-000	◆ 25601-000	
	◆ 30285-000			◆ 30285-000 ◆ 34977-000		
	◆ 44994-000			◆ 44989-000		
	◆ 45176-000	◆ 45177-000				
	RT 650 	09474-000	1½" SPRING PIN DIAMETER ◆ 32700-001 ◆ 32700-002 42750-000			

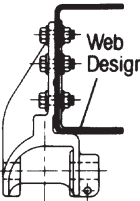
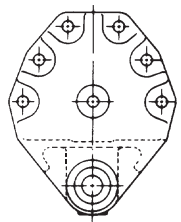
	1¼" SPRING PIN DIAMETER		1⅜" SPRING PIN DIAMETER		REMARKS	
	CASTING NO.	ORIGINAL PART NO.	REPLACEMENT PART NO.	ORIGINAL PART NO.		
WEB MOUNT  	26741-001	26742-001	26742-003			
		26742-003				
		26742-005	26742-015			27/16" hole location
		26742-007	26742-003			
		26742-009	26742-003			
		26742-011	26742-003			
	26741-002	26742-013	26742-003			27/16" hole location
		26742-015				
		26742-002	26742-004			
		26742-004	26742-016			27/16" hole location
26742-006						
31013-000	26742-008	26742-004				
	26742-010	26742-004				
	26742-012	26742-004				
	26742-014	26742-004			27/16" hole location	
	26742-016					
◆ 31026-000	◆ 31009-000		31124-001 ◆ 35394-001		Dodge	
◆ 33161-000	◆ 31128-001 ◆ 31128-002 ◆ 31128-003	◆ 31128-001 ◆ 31128-001	◆ 31128-004			
	◆ 35909-001				Dodge	
	◆ 33163-002 ◆ 35909-003	◆ 33163-002	◆ 33163-001			

◆ Obsolete, contact Hendrickson Truck Parts for available options.

#2 REAR FRAME HANGER

	CASTING NO.	ORIGINAL PART NO.	REPLACEMENT PART NO.	REMARKS
	◆ 20396-000	◆ 20396-000 ◆ 25915-000 ◆ 32517-000	◆ 32517-000 ◆ 32517-000	
	◆ 24497-000	◆ 24497-000 ◆ 31347-000	◆ 31347-000	
	35399-001	35400-001 35400-002		International
	35399-003	35400-003		International
	43182-000	45730-001 45730-002 45730-003	47875-001 47875-001 47875-001	Mack, •Volvo •Volvo Mack w/body bound bolts
	45160-000	43183-003 43183-004	57625-003 57625-003	GMC, Mack, Volvo
	45529-000	45530-001	57594-001	Ford
		45737-001	57594-002	
		45737-002 45737-003	57594-003 57594-004	AM General
	45732-000	45734-000		International
	45733-000	45735-000		International
	46049-000	46050-001	57625-001	Ford
		46050-003	57625-003	
		46050-004	57625-004	Freightliner
	47073-000	47074-001	57625-003	
	47075-000	47076-001	57594-001	Ford
		47076-002	57594-002	
		47076-003	57594-003	Peterbilt
		47076-004	57594-004	AM General
	47865-000	47875-001		Mack, Volvo
	50182-001	50183-001		Ford
		50183-002		
50183-003		50183-002	Peterbilt	
50183-004			International	
50183-005			Mack	
50186-000	50187-001		Mack, Volvo	
	50187-002		Freightliner	
50190-000	50191-001		Ford	
	50191-003			
59756-000	50191-004	50191-006	Freightliner	
	50191-006		International	
	59757-001		Volvo	
FLAME HARDENED SEVERE SERVICE				
	48581-001	48598-001	57594-001	Ford
		48598-002	57594-002	All others
		48598-003	57594-003	Peterbilt
	48592-001	48602-001	57625-001	Ford
		48602-002	57625-003	All others
		48602-003	57625-004	Freightliner
	49229-001	49230-001	47875-001	Mack, Volvo
	57624-001	57625-001		Ford
57625-003			All others	
57625-004			Freightliner	
57593-001	57594-001		Ford	
	57594-002		All others	
	57594-003		Peterbilt	

◆ **Obsolete**, contact Hendrickson Truck Parts for available options.

• Contact Hendrickson Truck Parts if a casting number has several part number options for the same original equipment manufacturer (OEM), it is necessary to have the vehicle VIN number available for reference.

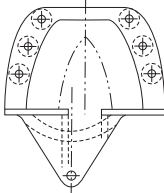
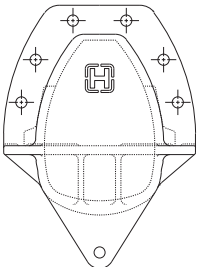

#2 REAR FRAME HANGER (CONTINUED)

CLAMP MOUNT	CASTING NO.	ORIGINAL PART NO.	REPLACEMENT PART NO.	REMARKS	
	EXTENDED LEAF				
	◆ 24482-001	◆ 24482-001	◆ 35016-011		
		◆ 24482-003	◆ 35016-011		
		◆ 24482-005	◆ 35016-011		
		◆ 31350-001	◆ 35016-011		
	◆ 24482-002	◆ 24482-002	◆ 35016-012		
		◆ 24482-004	◆ 35016-012		
		◆ 24482-006	◆ 35016-012		
		◆ 31350-002	◆ 35016-012		
	◆ 35401-001	◆ 35402-001		International	
	35401-002	35402-002		International	
	35401-003	35402-003			
	35401-004	35402-004			
	35403-001	35404-001			
	35403-002	35404-002			
	35403-003	35404-003			
	◆ 34986-001	◆ 35016-005	◆ 35016-011		
		◆ 35016-007	◆ 35016-011		
		◆ 35016-009	◆ 35016-011		
		◆ 35016-011			
◆ 34986-002	◆ 35016-013	◆ 35016-011			
	◆ 35016-006	◆ 35016-012			
	◆ 35016-008	◆ 35016-012			
	◆ 35016-010	◆ 35016-012			
	◆ 35016-012				
	◆ 35016-016	◆ 35016-012			
	RT 650		1 ½" SPRING PIN DIAMETER		
	◆ 09474-000	◆ 45161-001		Oshkosh LH	
		◆ 45161-002		Oshkosh RH	
		◆ 45768-001			
		◆ 45768-002			
		◆ 47381-001		Kenworth	
		◆ 47381-002		Kenworth	
	◆ 33796-000	◆ 47383-000		Kenworth	
		◆ 33496-000		International, Volvo	
		◆ 33494-000			
		◆ 42501-000			
		◆ 45417-000		Ford	
		◆ 45445-000		Volvo	
	45791-000 or 50595-000	◆ 47098-000		International	
		45792-001		Crane Carrier, GMC, Oshkosh, •Peterbilt, •Volvo, Freightliner	
45792-002			•Peterbilt		
45792-003			•Peterbilt		
46093-001	45792-004		•Volvo		
	◆ 50595-001	45792-001			
46093-002	46094-001	65035-001	Volvo		
46550-000 or 57795-000	46094-002	65035-002	Volvo		
	46551-001		Oshkosh, •Peterbilt, •Volvo		
	46551-002		Ford, •GMC		
	46551-003		•International, •Volvo		
	46551-004		Freightliner		
	46551-005		•GMC, •International		
	46551-006		Kenworth		
	46551-007		•Volvo		
46551-008		•Peterbilt			
57796-001	46551-004				

◆ **Obsolete**, contact Hendrickson Truck Parts for available options.

• Contact Hendrickson Truck Parts if a casting number has several part number options for the same original equipment manufacturer (OEM), it is necessary to have the vehicle VIN number available for reference.

#2 REAR FRAME HANGER (CONTINUED)

FLANGE MOUNT (OBSOLETE)	CASTING NO.	ORIGINAL PART NO.	REPLACEMENT PART NO.	REMARKS	
		◆ 04667-000	◆ 04667-000 ◆ 15583-000 ◆ 24933-000 ◆ 28966-000	◆ 57334-000 ◆ 57334-000 ◆ 57334-000 ◆ 57334-000	
		◆ 05811-000	◆ 05811-000		
		◆ 09171-000	◆ 09171-000 ◆ 19421-000	◆ 09171-000	
		◆ 25846-000	◆ 25846-000 ◆ 30843-000		No holes in bottom flange
		◆ 45178-000	◆ 45179-000		
2-BOLT PATTERN					
	◆ 27268-000	◆ 21655-004 ◆ 29437-001	◆ 21655-004		
		◆ 29437-002		Mack	
2-BOLT PATTERN EXTENDED LEAF					
	◆ 30173-000	◆ 28054-001 ◆ 28054-002	◆ 28054-001		
		◆ 28054-003		Brockway	
RT 650					
	◆ 09474-000	◆ 32700-001 ◆ 32700-002 ◆ 42750-000			

◆ **Obsolete**, contact Hendrickson Truck Parts for available options.

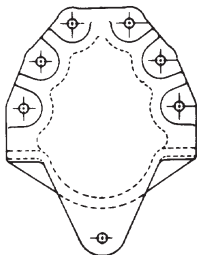
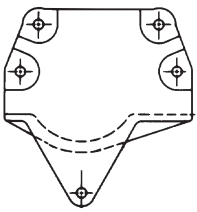

#2 REAR FRAME HANGER (CONTINUED)

WEB MOUNT (OBSOLETE)	CASTING NO.	ORIGINAL PART NO.	REPLACEMENT PART NO.	REMARKS
	◆ 31014-000	◆ 31125-001 ◆ 35395-001		Dodge
	◆ 31027-000	◆ 31129-001 ◆ 31129-002 ◆ 35910-001	◆ 31129-001	Dodge
	◆ 33162-000	◆ 33164-001 ◆ 35910-003		
	◆ 35151-001	◆ 35152-001 ◆ 35152-002 ◆ 35152-003	◆ 35152-001	GMC Dodge
	◆ 26753-001	◆ 26759-001	◆ 26759-011	27/16" hole location
		◆ 26759-003	◆ 26759-011	
		◆ 26759-005	◆ 26759-011	
	◆ 26753-002	◆ 26759-007	◆ 26759-011	27/16" hole location
		◆ 26759-009	◆ 26759-011	
		◆ 26759-011		
◆ 26759-002		◆ 26759-012		
◆ 31015-001	◆ 31126-001	◆ 31126-001		
	◆ 31126-003			
◆ 31015-002	◆ 31126-002			
	◆ 31126-004	◆ 31126-002		
UNDER MOUNT RT 650	1 1/2" SPRING PIN DIAMETER			
	CASTING NO.	ORIGINAL PART NO.	REPLACEMENT PART NO.	REMARKS
◆ 11063-001	◆ 11063-001		Crane Carrier, Seagrave, International	

◆ **Obsolete**, contact Hendrickson Truck Parts for available options.

#3 EXTENDED LEAF FRAME HANGER

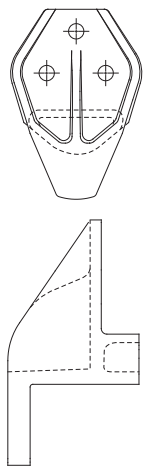
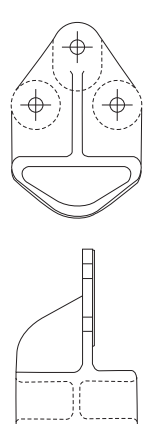
	CASTING NO.	ORIGINAL	REPLACEMENT	REMARKS	
		PART NO.	PART NO.		
WITH AXLE STOP 	◆ 46289-001	◆ 46331-001 ◆ 46331-005 ◆ 46331-010	◆ 46331-001 ◆ 46331-001	Ford, GMC Ford, GMC GMC, Western Star	
	46278-002	46331-002 46331-004 ◆ 46331-006 46331-008		Ford, GMC •Freightliner, •GMC Ford, GMC •Freightliner	
	46278-003	46331-003		GMC, Western Star	
	47313-000	46331-007 46331-013		Ford, GMC Peterbilt	
	49251-000	46331-011 46331-014		Ford, GMC Peterbilt	
	WITHOUT AXLE STOP 	26727-000	26727-000 27761-001 ◆ 27761-002 27761-003 27761-004 27761-005 27761-006 27761-007 27761-008	27761-006 27761-008 27761-006 27761-008 27761-006 27761-008 27761-006	1 3/8" hole location 1 7/8" hole location 2 1/4" hole location
		34987-000	45213-000	27761-006	
		◆ 45321-000	◆ 31042-000		Ford
		◆ 46278-001	◆ 46043-000		
		47313-000	47610-000		Ford

- ◆ **Obsolete**, contact Hendrickson Truck Parts for available options.
- Contact Hendrickson Truck Parts if a casting number has several part number options for the same original equipment manufacturer (OEM), it is necessary to have the vehicle VIN number available for reference.

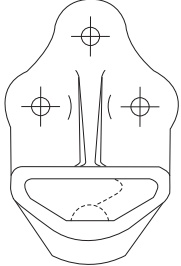

#3 EXTENDED LEAF FRAME HANGER (CONTINUED)

	CASTING NO.	ORIGINAL PART NO.	REPLACEMENT PART NO.	REMARKS
INBOARD 	WITH AXLE STOP			
	30248-001	◆ 30249-001 30249-009 ◆ 30249-014		Volvo
	30248-002	30249-002 30249-010 30249-017 30249-021	30249-021 30249-021	Volvo GMC, Western Star
	30248-003	◆ 30249-003 30249-011 ◆ 30249-015		Volvo Ford
	30248-004	30249-004 30249-006 ◆ 30249-007 30249-016	30249-004 30249-004	GMC
	30248-005	30249-005 30249-012 30249-018	30249-005	Volvo
	30248-006	30249-008 30249-013	30249-013	
	◆ 30248-007	◆ 30249-019		Ford
	35397-001 35397-002 35397-003 35397-004 35397-005 35397-006 35397-007 35397-008 35397-009 35397-010	35398-001 35398-002 35398-003 ◆ 35398-004 35398-005 ◆ 35398-006 ◆ 35398-007 ◆ 35398-008 ◆ 35398-009 ◆ 35398-010		International
	45812-001 45812-002 45812-003 45812-004 45812-005 45812-006 45812-007 45812-008	45813-001 45813-002 45813-003 45813-004 45813-005 45813-006 45813-007 45813-008		International

◆ **Obsolete**, contact Hendrickson Truck Parts for available options.

Components may vary by model, for part questions, contact Hendrickson Truck Parts toll-free at 866-755-5968 or email: truckparts@hendrickson-intl.com.

www.hendrickson-intl.com



Truck Suspension Systems
800 South Frontage Road
Woodridge, IL 60517-4904 USA

630.910.2800
Fax 630.910.2899